

EMILY PLACE IMPROVEMENTS

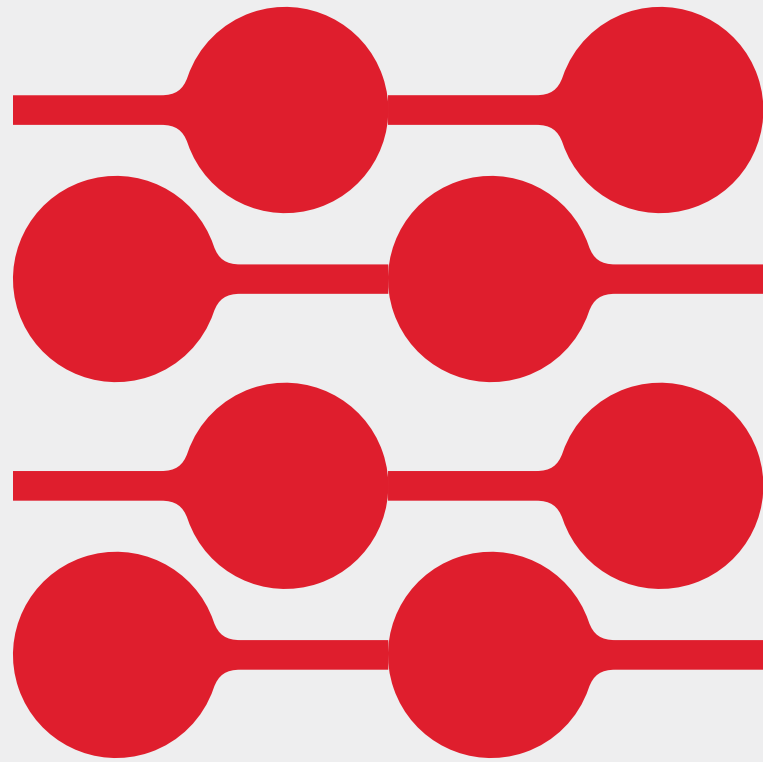

Updated concept design

Information pack

June 2024



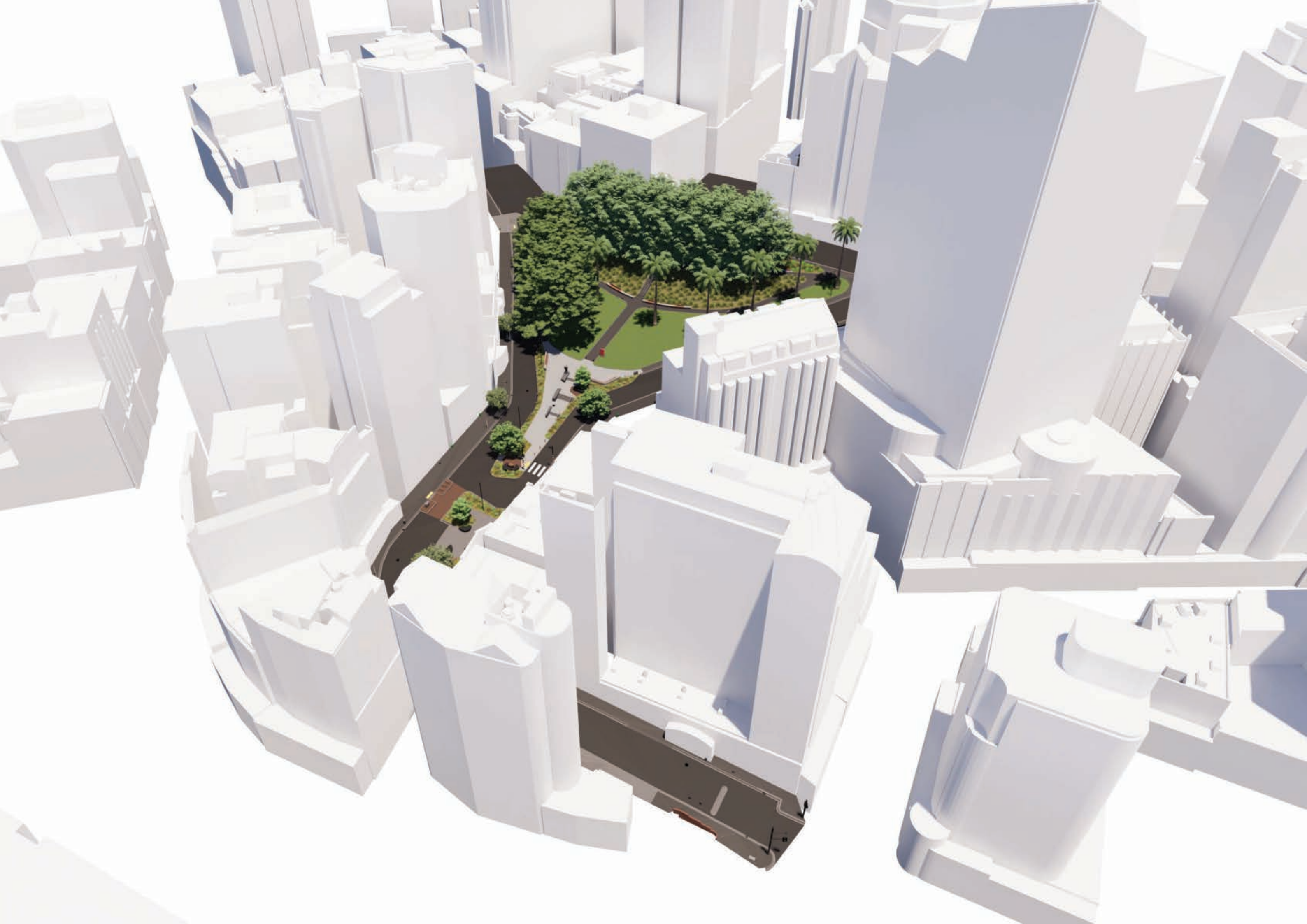

EMILY PLACE IMPROVEMENT PROJECT – UPDATED CONCEPT DESIGN

Introduction

We are progressing work on the Emily Place improvements project, a project that aims to provide a more people-focused street. This project and proposed improvements align with the City Centre Masterplan which focuses on making better use of city centre spaces and improving the quality of the environment.

The overall objectives for the Emily Place improvements project are to:

- Deliver a quality, accessible, attractive, distinctive and desirable public place.
- Create a destination that celebrates and responds to the cultural heritage and built form of the area
- Provide a space that empowers local community-led placemaking and activation opportunities.

Design update

A comprehensive engagement process was undertaken on the draft concept plan in late 2023.

The feedback we received through public engagement helped us further develop the updated design presented in this update.

While not every piece of feedback can be integrated into the design, we reviewed all individual responses received during engagement and we sincerely value the input.

Key feedback themes:

- Support for features that improve road and pedestrian safety.
- The four established palm trees on the western edge of the reserve are well-loved
- Emily Place’s green space, trees and reserve provide an urban oasis that people value and want to connect with.

- Emily Place’s culture and heritage is valued and should be celebrated.
- There was mixed sentiment about parking priorities including the need to balance short vs long term parking and consider residents’ needs.
- There were ideas for further additions to the draft concept plan such as changes to the community plaza and to traffic flow.
- There were concerns about anti-social behaviour and safety in Emily Place

More information:

To find out more about how the design responds to community feedback and for the full community engagement report.

<https://progressakl.co.nz/emilyplace>

CONCEPT DESIGN SNAPSHOT

Pedestrian priority and safety enhancements

- Multiple crossing locations, including a zebra crossing in mid-Emily Place
- Traffic calming measures, such as speed humps and reduced road widths
- Slip lane routing and manoeuvring space adjusted for improved access
- Safety improvements at the Eden Crescent and Shortland Street intersections
- Removal of the existing widening of the northern footpath installed as part of the Innovating Streets project, rebuild the footpath slightly wider than its original condition

Loading and car parking provision

- A total of 42 car parking spaces, including 6 loading zone spaces, two car share car parks and 34 Pay & Display

Space usability and greening opportunities

- A community plaza in mid Emily Place, with an open flat space adjoining the grass area in the reserve, terraced areas along with an at-grade pathway. Separation between people and cars with new garden beds
- New seating in mid Emily Place and the reserve
- Remove one exotic tree and replace with two new native trees in mid-Emily Place
- New low-level planting and raised planters in mid-Emily Place
- Retaining the 4 established palm trees on the western edge of the reserve

Safety improvements in the reserve

- Handrails for the stairs in the reserve
- Lighting improvements, including addition of lighting along the central north-south path in the reserve

Stormwater management

- Increase in cesspit capacity
- More stormwater absorption from new soft landscaping areas. A passive irrigation system will be explored in future design stages

Cultural design opportunities

In partnership with Ngāti Whātua Ōrākei and Ngāti Maru, the following design opportunities have been identified and will continue to be explored to celebrate the story of Te Rerenga Ora Iti the former headland, original shoreline, and native flora and fauna

- Incorporating cultural design in feature seating and ground markings
- Inclusion of mahi toi (art) and the placement of kōhatu (stones/rocks)
- Opportunities for storytelling and educational signage
- Collaboration opportunities with iwi nurseries to select and source native plants and trees locally

EMILY PLACE | CONCEPT DESIGN

CONCEPT PLAN

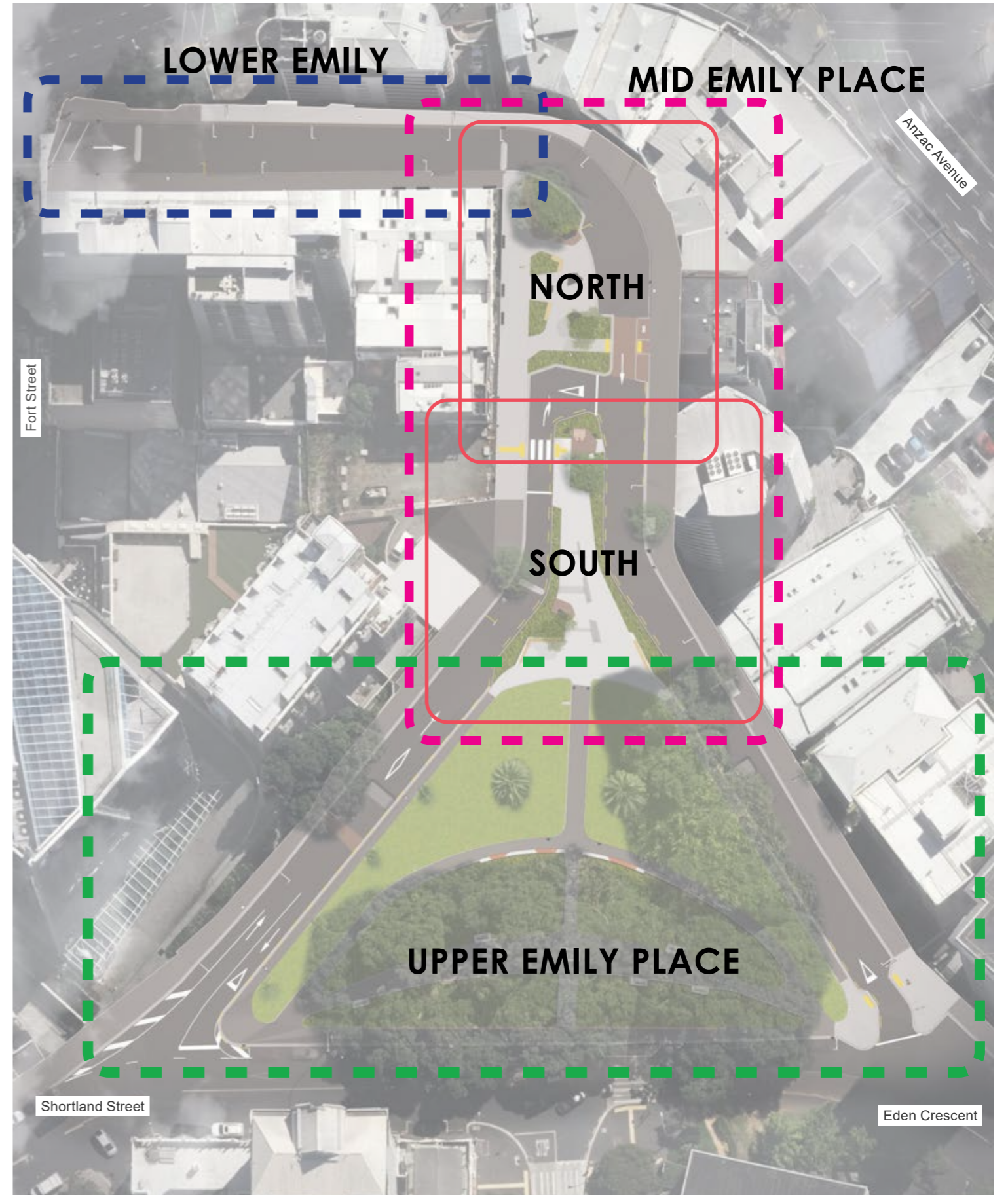

LOWER EMILY PLACE | CONCEPT DESIGN

CONCEPT PLAN

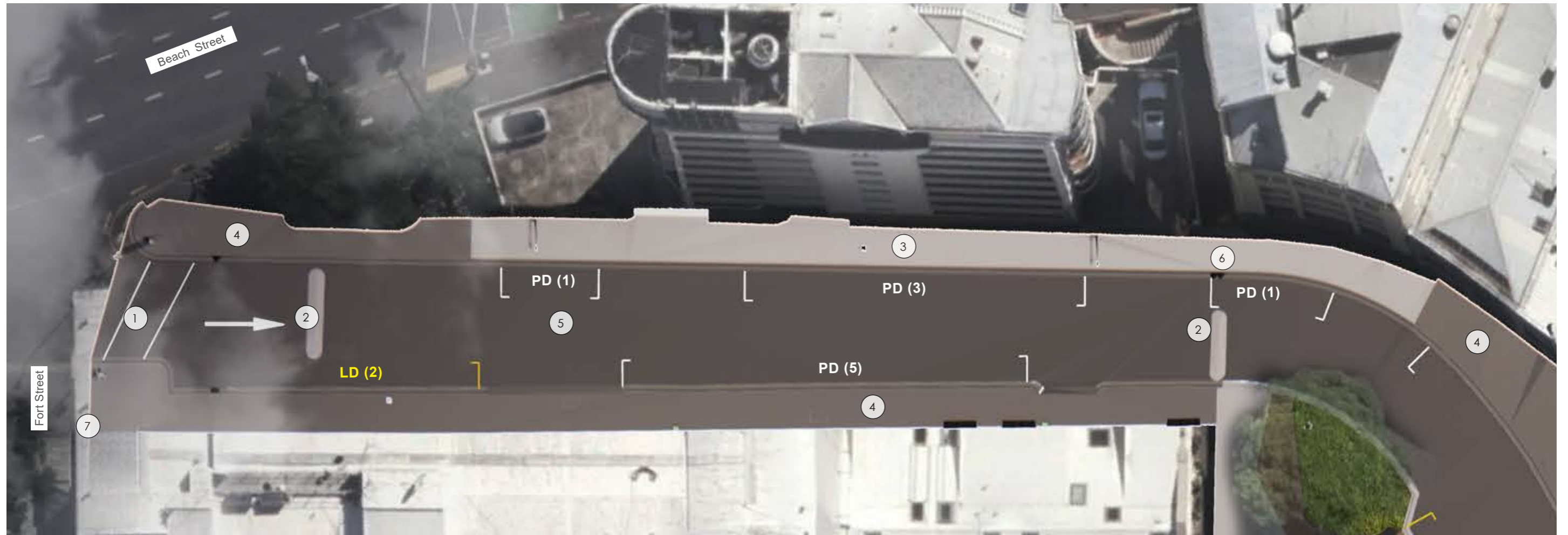

1. Existing signalised pedestrian crossing retained
2. Proposed speed hump
3. Proposed widened footpath
4. Existing footpath retained
5. Rationalised road carriageway width
6. Proposed upgrade to existing catchpit
7. Proposed wayfinding signage at corner of building

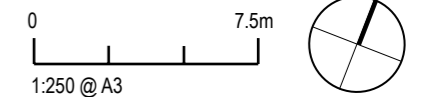

MID EMILY PLACE NORTH | CONCEPT DESIGN

CONCEPT PLAN

1. Proposed footpath pavement, garden beds and seating
2. Proposed feature rocks/kōhatu (cultural expression)
3. Proposed feature footpath paving (cultural expression)
4. Proposed feature carriageway paving (cultural expression)
5. Proposed raised planters with seating
6. Proposed enhancement to existing garden bed around existing tree
7. Proposed street tree
8. Proposed kerb buildout with bike stands and bin
9. Rationalised road carriageway width
10. Relocated slip lane (1x existing street tree to be removed)
11. Proposed catchpit
12. Existing footpath retained

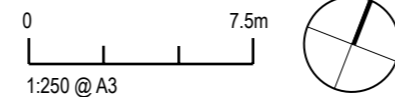

MID EMILY PLACE SOUTH | CONCEPT DESIGN

CONCEPT PLAN

1. Community Plaza - proposed footpath pavement, garden beds, steps/terraces and seating
2. Proposed feature plinth and artwork (cultural expression)
3. Proposed feature rocks/kōhatu (cultural expression)
4. Proposed feature footpath paving (cultural expression)
5. Proposed feature carriageway paving (cultural expression)
6. Proposed feature tree
7. Proposed zebra crossing
8. Proposed planted buffer between carriageway and pedestrian area / footpath
9. Proposed enhancement to existing garden bed around existing tree
10. Rationalised road carriageway width
11. Relocated slip lane (1x existing street tree to be removed)
12. Proposed catchpit
13. Proposed bike stand
14. Proposed speed hump
15. Proposed new footpath pavement
16. Existing footpath retained
17. Proposed location for community notice board, library and picnic table



UPPER EMILY PLACE | CONCEPT DESIGN

CONCEPT PLAN

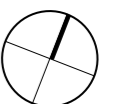

MANA WHENUA ENGAGEMENT | CULTURAL DESIGN OPPORTUNITIES

In partnership with Ngāti Whātua Ōrākei and Ngāti Maru, the following cultural narrative opportunities have been identified as key aspects to be considered and reflected in cultural design:

- Te Rerenga Ora Iti the former headland
- Original shoreline
- Native flora and fauna

The key outcome of the cultural design features is to support the design narrative and tell the story of its unique site history. We want interaction with the cultural features of Emily Place to be a focus and talking point, encouraging new and returning visitors to the area.

Three cultural design opportunities have been further explored through a design study process

Design Narrative 1

Te Rerenga Ora Iti the former headland



Design Narrative 2

Original shoreline

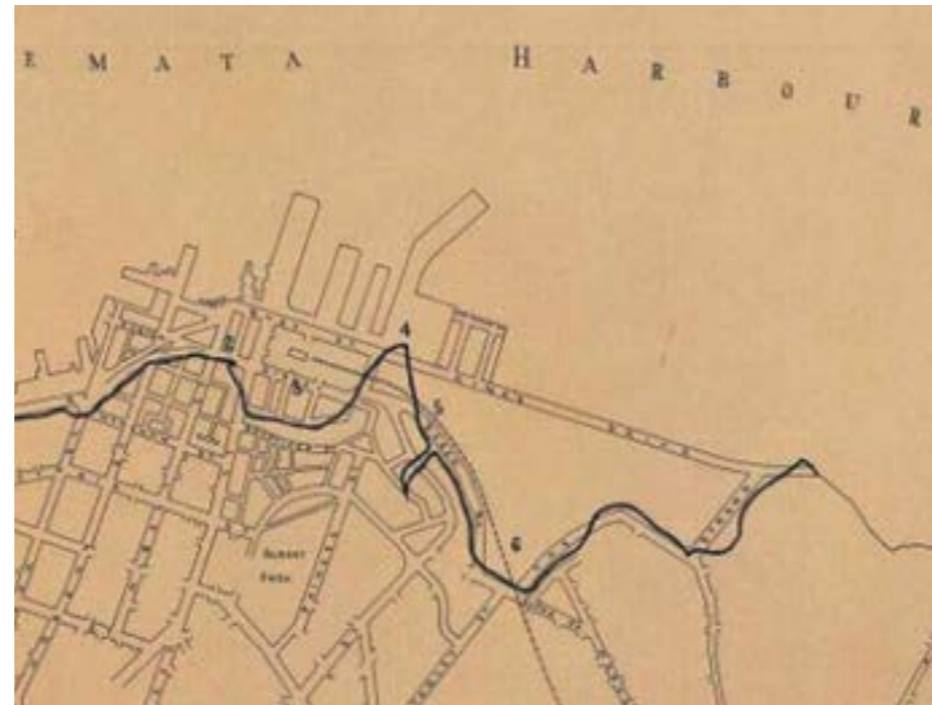

Design Narrative 3

Native flora and fauna



MANA WHENUA ENGAGEMENT | DESIGN OPPORTUNITIES

Design Opportunity 1 : Reserve Feature Seat

Celebrate the story of Te Rerenga Ora Iti and Emily Place

Location



Illustrative Views



MANA WHENUA ENGAGEMENT | DESIGN OPPORTUNITIES

Design Opportunity 1 : Reserve Feature Seat

Cultural Design Integration Concept

- Concrete with steel sheet and/or timber overlay.
- View from an elevated area of the site, overlooking the cultural design integration provided in the lower area.
- Focal point when walking up Emily Place towards the reserve.
- Opportunity to use steel sheets with laser-cut patterns that reflect cultural narrative.
- Opportunity for timber materials to feature engraved patterns that reflect cultural narrative.

Precedent Images



MANA WHENUA ENGAGEMENT | DESIGN OPPORTUNITIES

Design Opportunity 2 : Feature Plinths

Celebrate the original landform of Point Britomart

Location



Illustrative Views



MANA WHENUA ENGAGEMENT | DESIGN OPPORTUNITIES

Design Opportunity 2 : Feature Plinths

Cultural Design Integration Concept

- Concrete plinths positioned to guide the route along the primary pedestrian access.
- Opportunity for the surfaces of concrete plinths to feature sandblasted patterns that reflect cultural narrative.
- Opportunity to place a sculpture on a plinth.

Precedent Images

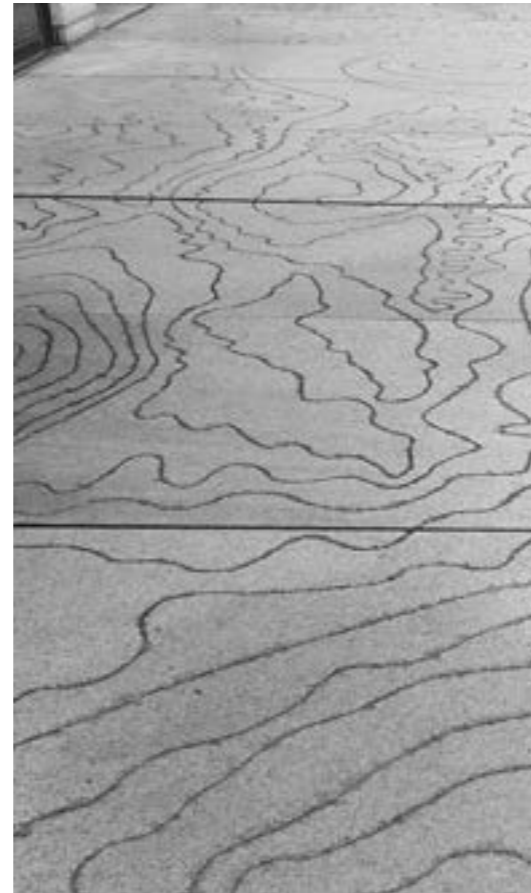

MANA WHENUA ENGAGEMENT | DESIGN OPPORTUNITIES

Design Opportunity 3 : Kōhatu

Celebrate the original landform of Point Britomart

Location



Illustrative Views



MANA WHENUA ENGAGEMENT | DESIGN OPPORTUNITIES

Design Opportunity 3 : Kōhatu

Cultural Design Integration Concept

- Natural materials that complement the constructed nature of the streetscape.
- Opportunity to connect with the native land formations and geological features.
- Opportunity to integrate artwork.

Precedent Images



MANA WHENUA ENGAGEMENT | DESIGN OPPORTUNITIES

Design Opportunity 4 : Feature Paving

Celebrate the original landform of Point Britomart

Location

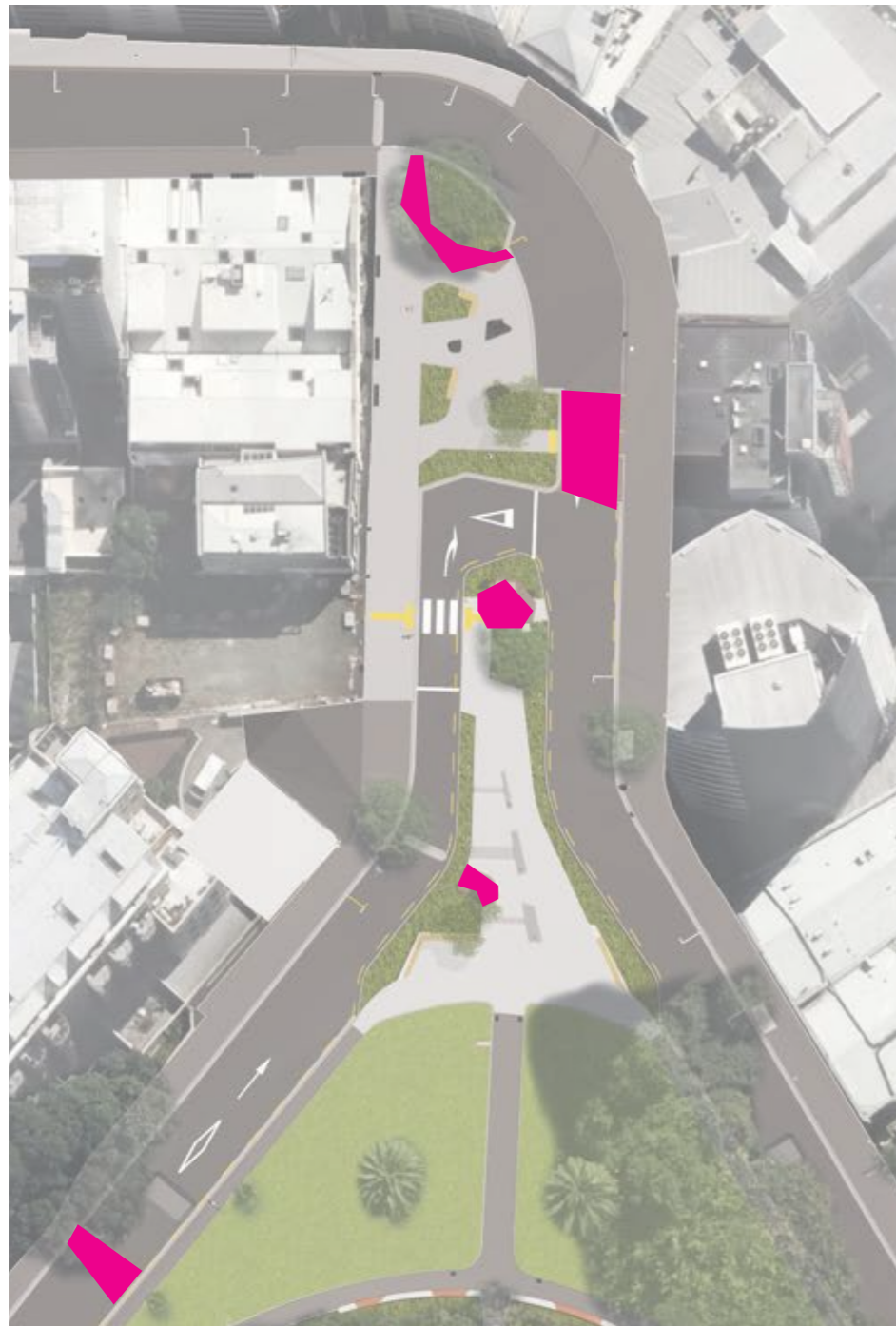

Illustrative Views



MANA WHENUA ENGAGEMENT | DESIGN OPPORTUNITIES

Design Opportunity 4 : Feature Paving

Cultural Design Integration Concept

- Feature paving to be positioned at nodes, including seating areas and carriageway thresholds.
- Concrete surfaces to incorporate sandblasted patterns that reflect cultural narrative.
- Carriageway surfaces to include painted patterns that reflect cultural narrative.

Precedent Images

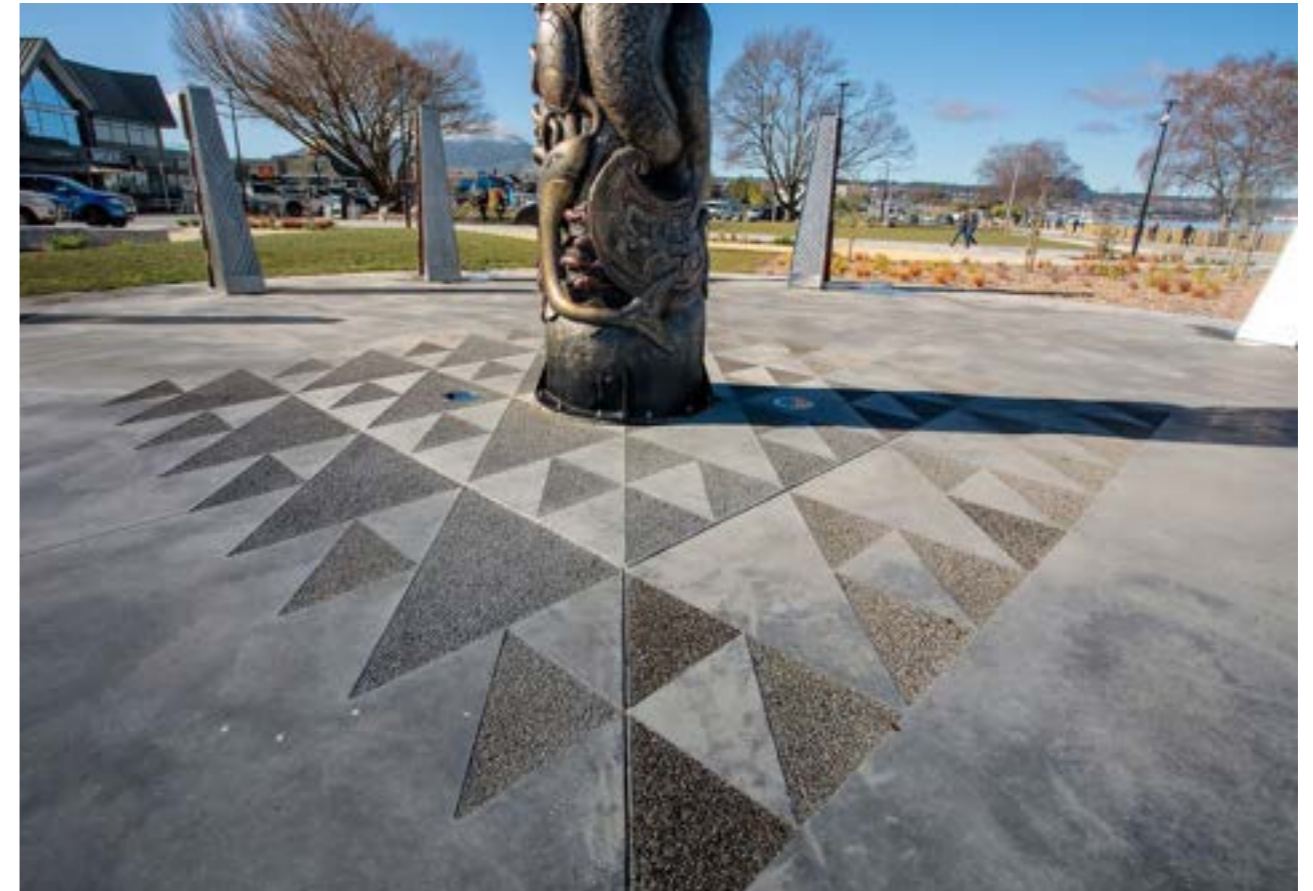

PARKING & SERVICES STRATEGY

PROPOSED CONCEPT



Car Parking

	Existing	Proposed
Pay & Display (PD)	31	34
Resident (R)	10	0
Loading zone (LZ)	3	6
Shared (SD)	2	2

Total loss / gain: -4

Bike Parking

	Existing	Proposed
Bike stands (B)	20	20

Total: +0

Quantity based on measured parking capacity (refer to Parking Survey in Feasibility chapter)

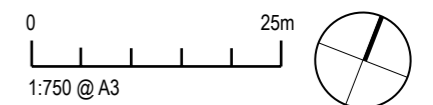

LOWER EMILY PLACE | CONCEPT DESIGN

ILLUSTRATIVE VIEW



MID EMILY PLACE NORTH | CONCEPT DESIGN

ILLUSTRATIVE VIEW



MID EMILY PLACE SOUTH | CONCEPT DESIGN

ILLUSTRATIVE VIEW



MID EMILY PLACE SOUTH | CONCEPT DESIGN

ILLUSTRATIVE VIEW



UPPER EMILY PLACE | CONCEPT DESIGN

ILLUSTRATIVE VIEW



UPPER EMILY PLACE | CONCEPT DESIGN

ILLUSTRATIVE VIEW

